

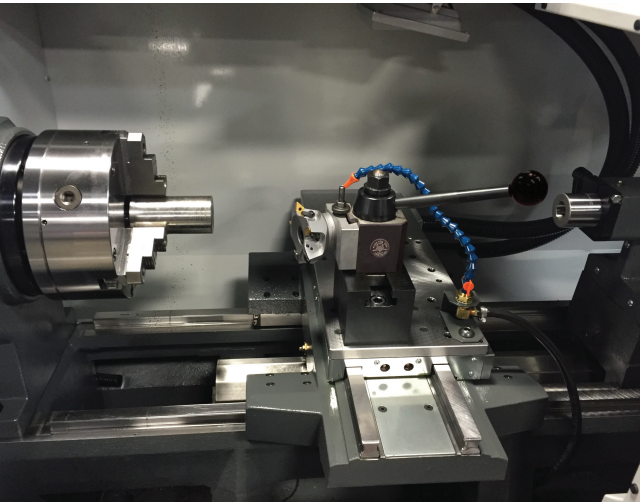

ENGINE & TOOL ROOM LATHE PRODUCT APPLICATIONS

Thanks to the unique SpinSelect™ Multi-Pocket selectable tool holder, it's time to rethink the range, complexity and volume of parts that your tool room lathe can produce.

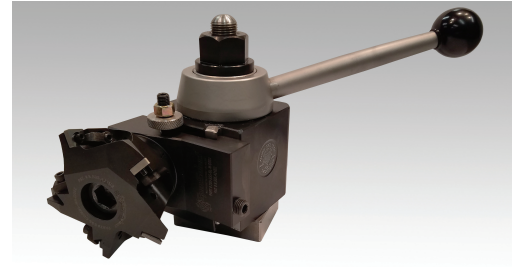

FEATURES & BENEFITS

- Each SpinSelect™ head can hold up to five inserts
- Reduce tool indexing time by 85%...a 1/4 turn of a socket head cap screw is all it takes to index to a new tool
- Offline insert changes significantly reduces set-up times
- Each insert can be a different geometry...example; C, D, V, etc.
- Insert index repeatability is approx .0007"
- Improved insert wear
- Each SpinSelect™ pocket is 30% stronger than its conventional shank counterpart
- Reduces change-over/set-up times by 50% to 85% for most lathe parts
- Cuts downtime due to fewer trips to the tool crib

CONSTRUCTION

- 100% USA-made
- Produced from hardened & tempered 4340/4140 alloy steel
- Machined from wrought bar stock
- Thru the tool coolant design

Ft. Worth Texas Machine Shop Owner...
"We used to think of our tool room lathe as sort of dinosaur, good for one-off part production or very short runs. Now however, our SpinSelect™ equipped tool room lathe can perform a much wider range of operations, plus faster feeds...it's like found capacity without spending a dime on new machines."



SCAN HERE TO VIEW SpinSelect™
TOOL HOLDERS IN ACTION





ENGINE & TOOL ROOM LATHE PRODUCT APPLICATIONS

SpinSelect™ Multi-Pocket selectable tool holders are a two-part system consisting of a Head and Base. Modern Industries can manufacture Head and Base combinations that work best on your particular lathe...enabling you to realize the full range of operating advantages and ROI each SpinSelect™ tool holder is engineered to deliver.

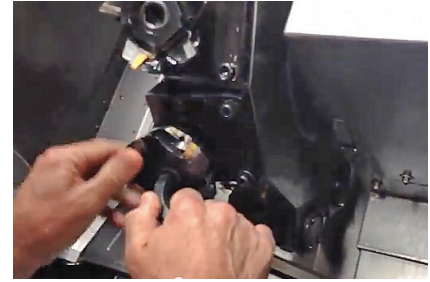

HEADS

SpinSelect™ heads are available in a number of popular sizes, tool holding insert geometries, insert relief angles, tool holder codes, insert relief codes, insert sizes and other operating parameters.

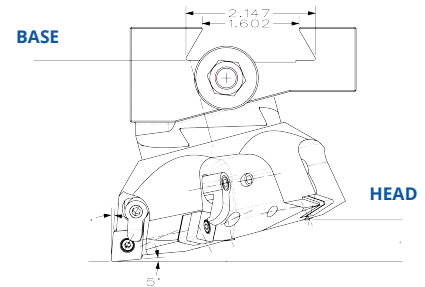

HEADS	
Part Number	Spin Select Head Description (s)
SS5-COMBL-M4-D001	Combo Tool Head with the Following Inserts, CNMG43, DNMG43, VNMG33, TMPR4, and Top Notch Size 3, Medium Head Left Hand
SS5-COMBL-M4-D002	Combo Tool Head with the Following Inserts, CNMG43, DNMG43, VNMG33, and (2) Top Notch Size 3, Medium Head Left Hand
SS5-COMBL-M4-D003	Combo Tool Head with the Following Inserts, CNMG43, DNMG43, VNMG33, Laydown Threader Size 16, and Top Notch Size 3, Medium Head Left Hand
SS5-MVPNL-L4-V001	VNMG Insert, 1/2 IC, Large Head Left Hand
SS5-MCLNL-M4-C001	CNMG insert, 1/2 IC, Medium Head Left Hand
SS5-MCLNL-L5-C001	CNMG Insert 5/8 IC Large Head Left Hand
SS5-MDJNL-M4-D001	DNMG Insert, 1/2 IC, Medium Head Left Hand
SS5-MDJNL-M4-D002	DNMG Insert, 1/2 IC, Medium Head Left Hand
SS5-MWLNL-M4-W001	WNMG Insert, 1/2 IC, Medium Head Left Hand
SS5-MVPNL-M3-V001	VNMG Insert, 3/8 IC, Medium Head Left Hand
SS5-CEL16-M3-L001	Lay Down Threader/Groover, size 16, Medium Head Left Hand
SS5-NNDSL-M3-N001	Top Notch Threader/Groover, size 3, Medium Head Left Hand
	NOTE: All of the above configurations are available right-hand.

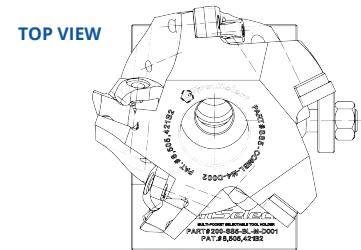

BASES

SpinSelect™ bases are produced from high grade tool steel in standard right hand and left hand configurations. Bases are stocked as blanks, then custom finished to precisely fit on your machine/turret for optimum performance.

BASES	
Part Number	Spin Select Base Description (s)
SS5-BL-L-D002	Large Base Left Hand with 6 Inch Dovetail Connection Tool Post
SS5-BL-L-D001	Large Base Left Hand with 5 Inch Dovetail Connection Tool Post
SS5-BL-M-D002	Medium Base Left Hand with 4 Inch Dovetail Connection Tool Post
SS5-BL-M-D001	Medium Base Left Hand with 3.5 Inch Dovetail Connection Tool Post
SS5-BL-M-S001	Medium Base Left Hand on a 1 Inch Square Block Mount
SS5-BR-M-S001	Medium Base Right Hand on a 1 Inch Square Block Mount
SS5-BL-S-D002	Small Base Left Hand with 3 Inch Dovetail Connection Tool Post
SS5-BL-S-D001	Small Base Left Hand with 2.5 Inch Dovetail Connection Tool Post
	NOTE: Bases are stocked as blanks and custom finished to fit your Machine/Turret. Provide the following information: 1. Make-Model of your turret.

